

# Dromex



## 3 PLY DISPOSABLE FACE MASK DROMEX F103



DR-F103

### Description

Dromex® F103, lightweight and easy to breathe, disposable 3 ply face masks, is intended to cover the nose and mouth in order to minimise the incidence of cross infection of airborne infective bacterial agents generated from the respiratory tract, suitable for use in medical, dental, food preparation and other clean or sensitive environments.

Dromex® DR-F103 disposable 3 ply face mask, features the following:

- An adjustable soft aluminium nose bar allows for ease of moulding onto nose and optimum fit
- 100% Latex free ear band loop prevents irritation and eliminates pressure on the ear
- Hypoallergenic due to the polypropylene synthetic material preventing allergies
- Glass fibre free
- Automatic ultrasonic bonding adds to the cleanliness of the mask
- Lightweight and comfortable to use in humid environments
- A 3 pleat triple layer construction provides stronger support to the mask.

### Special Instructions

These masks do not supply oxygen. DO NOT use in oxygen deficient atmospheres (e.g. tanks or other poorly ventilated areas).

The lifetime of the mask depends on many factors including the work rate, the airflow and the concentration of the contaminant in the atmosphere.

Masks should be discarded and replaced with a new one if:

- The mask is removed while in a contaminated area.
- Excessive clogging of the mask causes breathing difficulty or discomfort.
- The mask becomes damaged.
- The unused masks are not in their protective packaging (once open they are activated).

Do not use these respirators or enter in an area where:

- The Oxygen concentration is not known or is less than 19%.
- Contaminants or their concentrations are unknown or are known to be immediately dangerous to life or health.
- Particulate concentrations exceed levels fixed by the applicable health and safety regulations.
- The requirement for leak tightness is unlikely to be achieved if worn against a beard or facial stubble.
- Do not use in explosive atmospheres.
- Not to be used for firefighting.

When transporting this product, retain in its original packaging and keep away from mechanical and chemical hazards.

None of the materials or processes used in the manufacture of these products are known to be harmful to the wearer. The manufacturer has examined under the system for ensuring quality of production by means of monitoring and inspection.

These disposable half masks are designed to accommodate the basic safety requirements and standards for Personal Protective Equipment.

The information contained herein is intended to assist the wearer in the selection of personal protective equipment.

Actual conditions of use cannot be directly simulated in a test environment therefore it is the responsibility of the user and not the manufacturer or supplier to determine the disposable half mask suitability for the intended use.

### Compliance & Conformity

This mask is manufactured to EN ISO 13485:2016 requirements and is subject to yearly surveillance.

CE approved.

### Specifications

Style:	Blue colour, triple layer (3 Ply) disposable, ear loop type, adjustable dust mask
Bacterial filtering efficiency:	95%
Materials:	Spun bonded polypropylene non-woven fabric with filter in between
Specific materials:	Outer Coverstock - 20 gsm Middle Filter Medium - White 25gsm Inner Coverstock - 25gsm Loops - Elasticated, polypropylene covered

### Packaging, Storage & Obsolescence

DR-F103 - Packed as 50 masks in a box and 50 boxes in a carton for shipping.

Keep unused masks in their closed box and store in a dry non contaminated area between -15 degrees and 40 degrees Celsius and away from high frequency equipment.

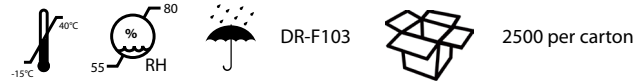

### Cleaning & Maintenance

This is a disposable item therefore cleaning and maintenance is not required.

### Shelf life

3 years. The expiry date of each item is indicated on box packaging.

### How to put on a face mask

1. Clean your hands with soap and water or hand sanitizer before touching the mask.
2. Remove a mask from the box and make sure there are no obvious tears or holes in either side of the mask.
3. The blue colored side of the mask will be the front and will face away from you. The white side touches your face.
4. Place mask ear loops around each ear.
5. Mold the aluminium nose bridge to the shape of your nose.
6. Pull the bottom of the mask over your mouth and chin.

### How to remove a face mask

1. Clean your hands with soap and water or hand sanitizer before touching the mask. Avoid touching the front of the mask. The front of the mask is contaminated. Only touch the ear loop.
2. Hold both of the ear loops and gently lift and remove the mask away from your face
3. Throw the mask in the trash. Clean your hands with soap and water or hand sanitizer.

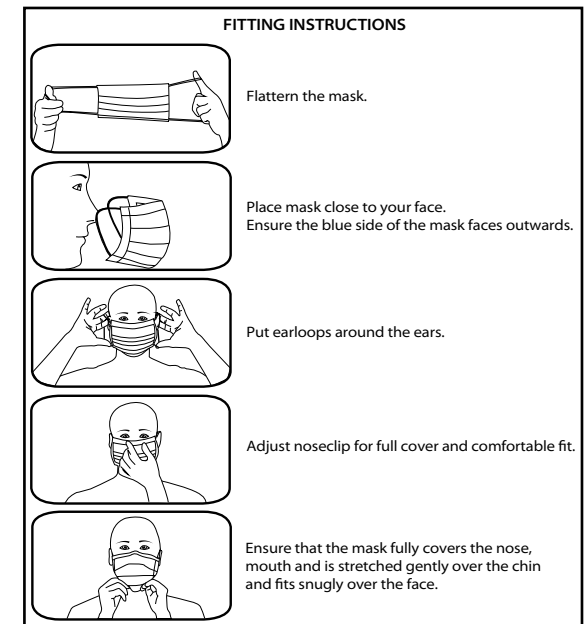

### Disposal

All industrial waste should be disposed of correctly according to local regulations and good disposal practice. Respiratory protective devices should be disposed of considering the hazardous substances they were used for. Please consider recycling.

Dromex: Unit 1, 1 Blase Road, New Germany, 3620, South Africa  
T. +27(31) 713 1960 E. info@dromex.co.za  
www.dromex.co.za